

**Consulting Services for the
Conceptual and Detailed Designs of Furniture & Equipment related to
Chinese Medicine Culture for the
Hong Kong Chinese Medicine Hospital**

Appendix 4

CMH Zoning Layout Plans

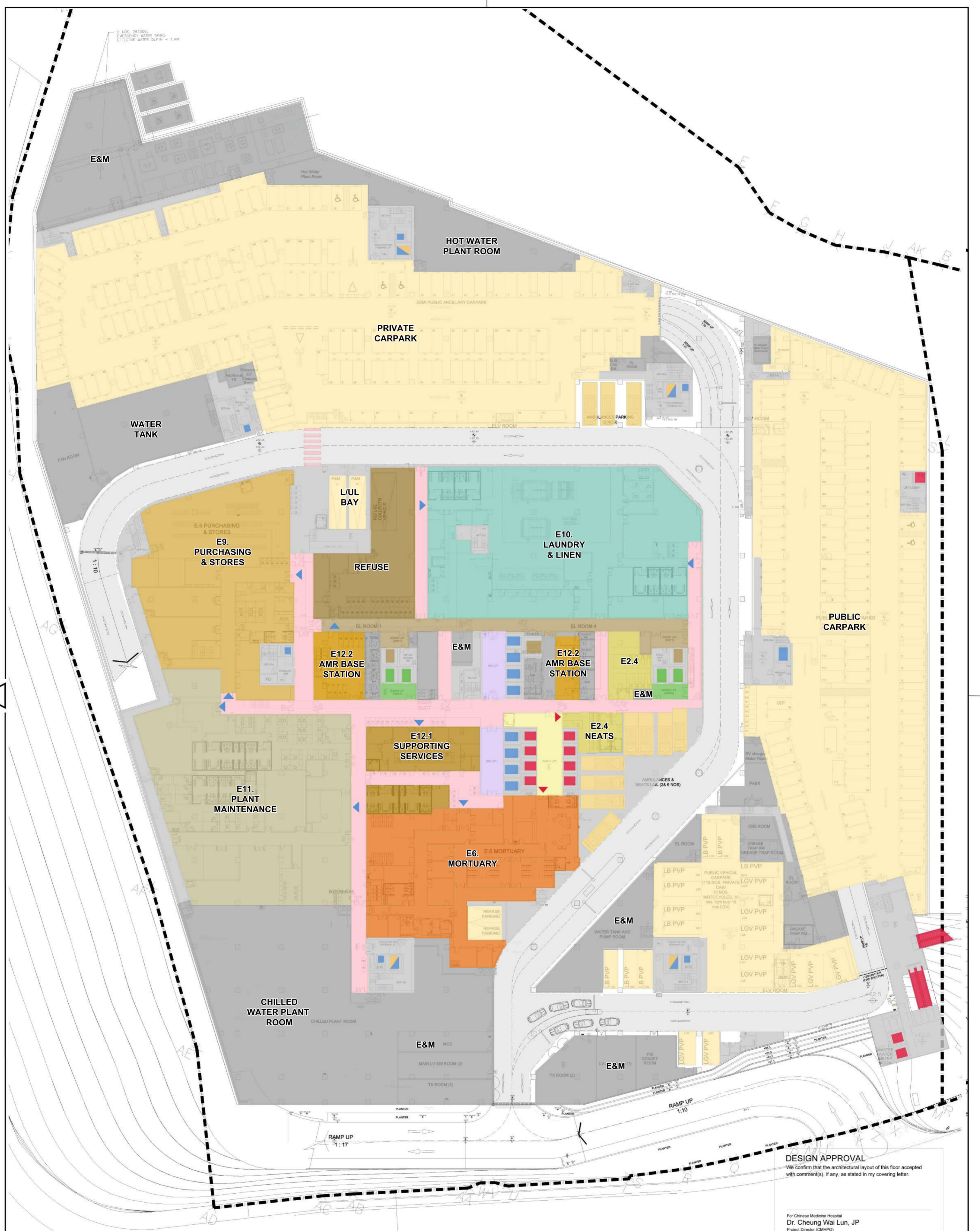

DESIGN APPROVAL
 We confirm that the architectural layout of this floor accepted with comment(s), if any, as stated in my covering letter.

For Chinese Medicine Hospital
Dr. Cheung Wai Lun, JP
 Project Director (CMH-PO)
 Food and Health Bureau

Date: _____

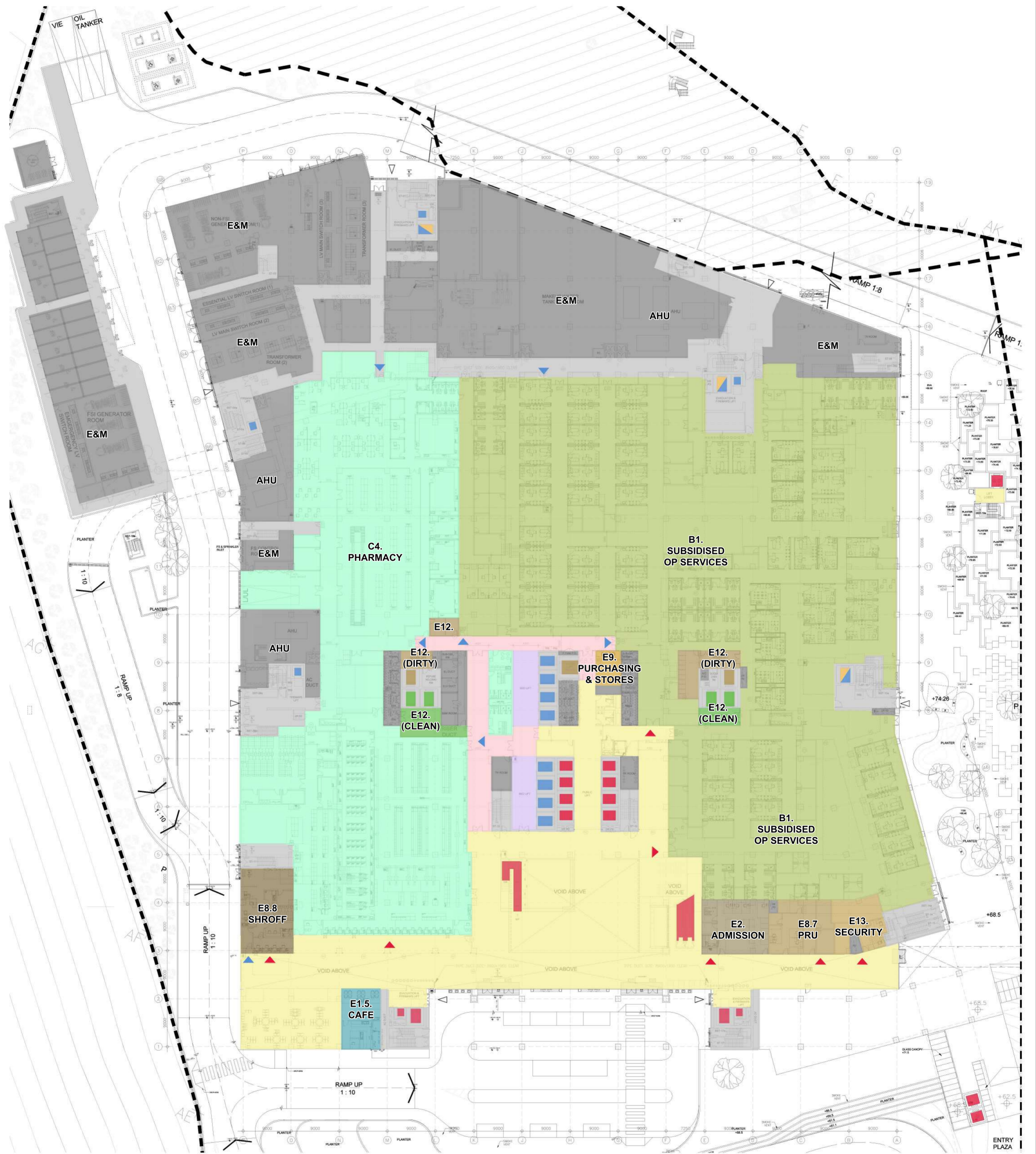

DESIGN APPROVAL
 We confirm that the architectural layout of this floor accepted with comment(s), if any, as stated in my covering letter.

For Chinese Medicine Hospital
 Dr. Cheung Wai Lun, JP
 Project Director (CMHPO)
 Food and Health Bureau

Date: _____

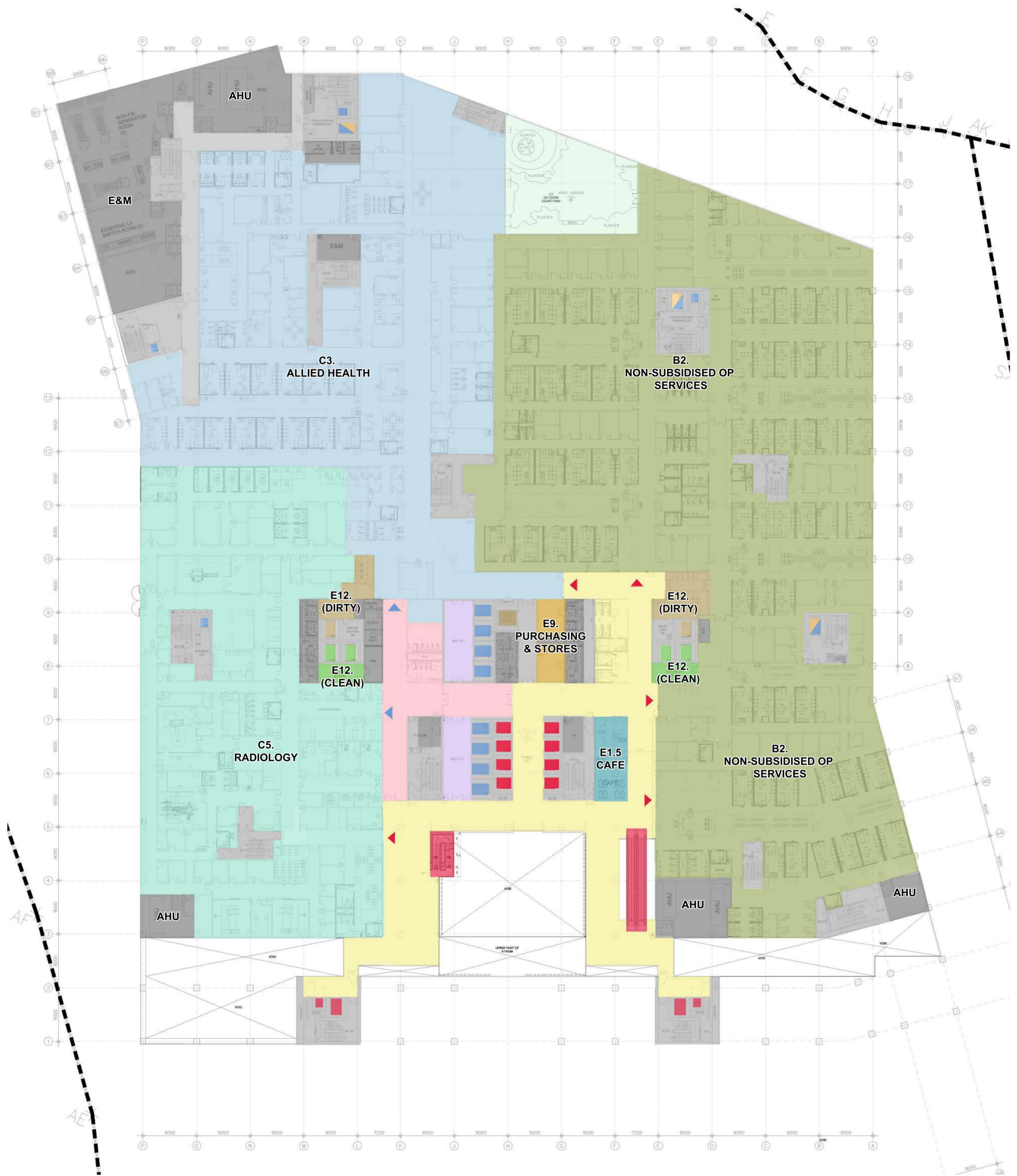

DESIGN APPROVAL
 We confirm that the architectural layout of this floor accepted with comment(s), if any, as stated in my covering letter.

For Chinese Medicine Hospital
Dr. Cheung Wai Lun, JP
 Project Director (CMHPD)
 Food and Health Bureau

Date: _____



DESIGN APPROVAL
 We confirm that the architectural layout of this floor accepted with comment(s), if any, as stated in my covering letter.

For Chinese Medicine Hospital
 Dr. Cheung Wai Lun, JP
 Project Director (CMHPD)
 Food and Health Bureau

Date: _____

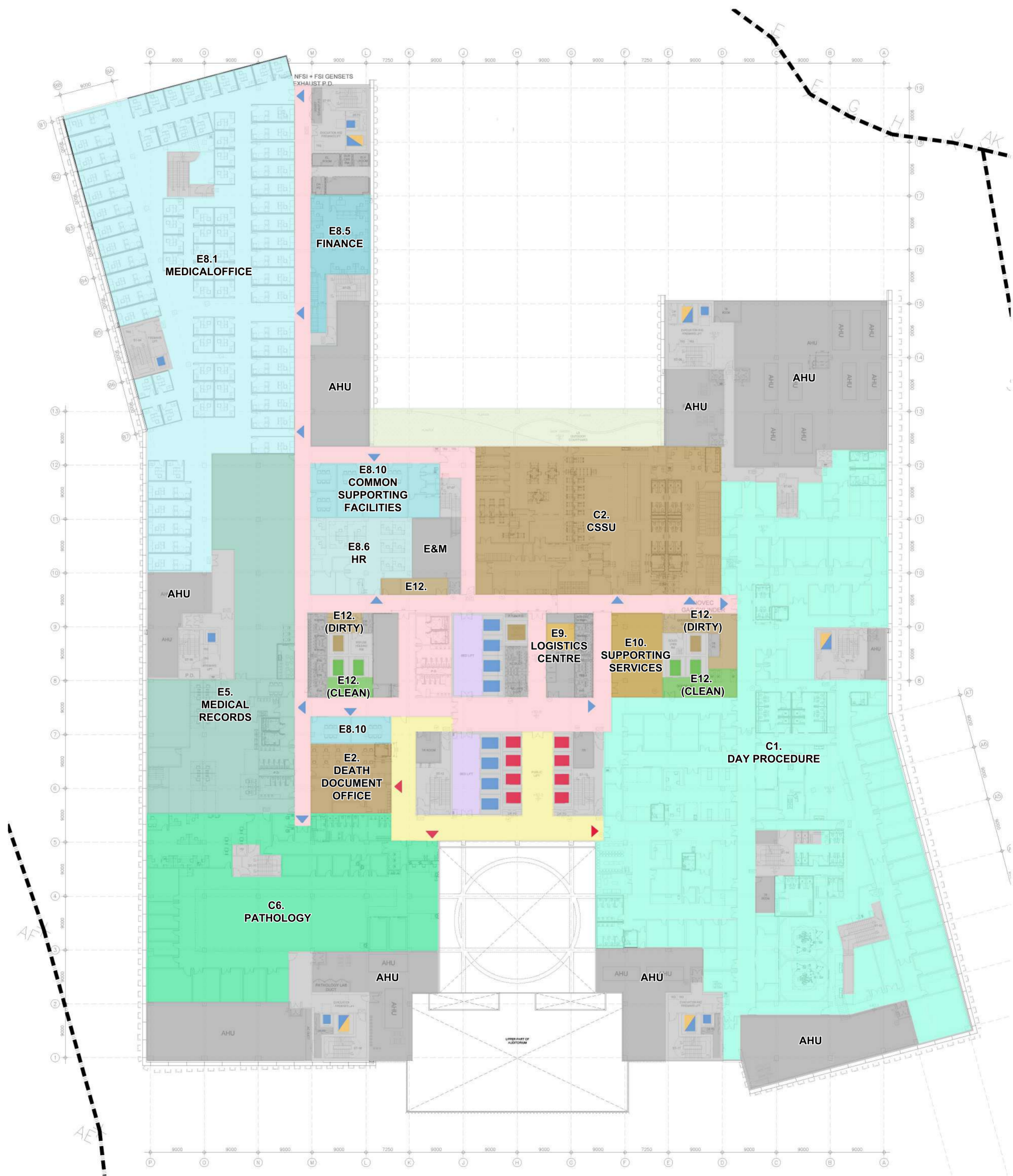

DESIGN APPROVAL
 We confirm that the architectural layout of this floor accepted with comment(s), if any, as stated in my covering letter.

For Chinese Medicine Hospital
 Dr. Cheung Wai Lun, JP
 Project Director (CMHPO)
 Food and Health Bureau

Date: _____



DESIGN APPROVAL
 We confirm that the architectural layout of this floor accepted with comment(s), if any, as stated in my covering letter.

For Chinese Medicine Hospital
Dr. Cheung Wai Lun, JP
 Project Director (CMHPO)
 Food and Health Bureau

Date: _____

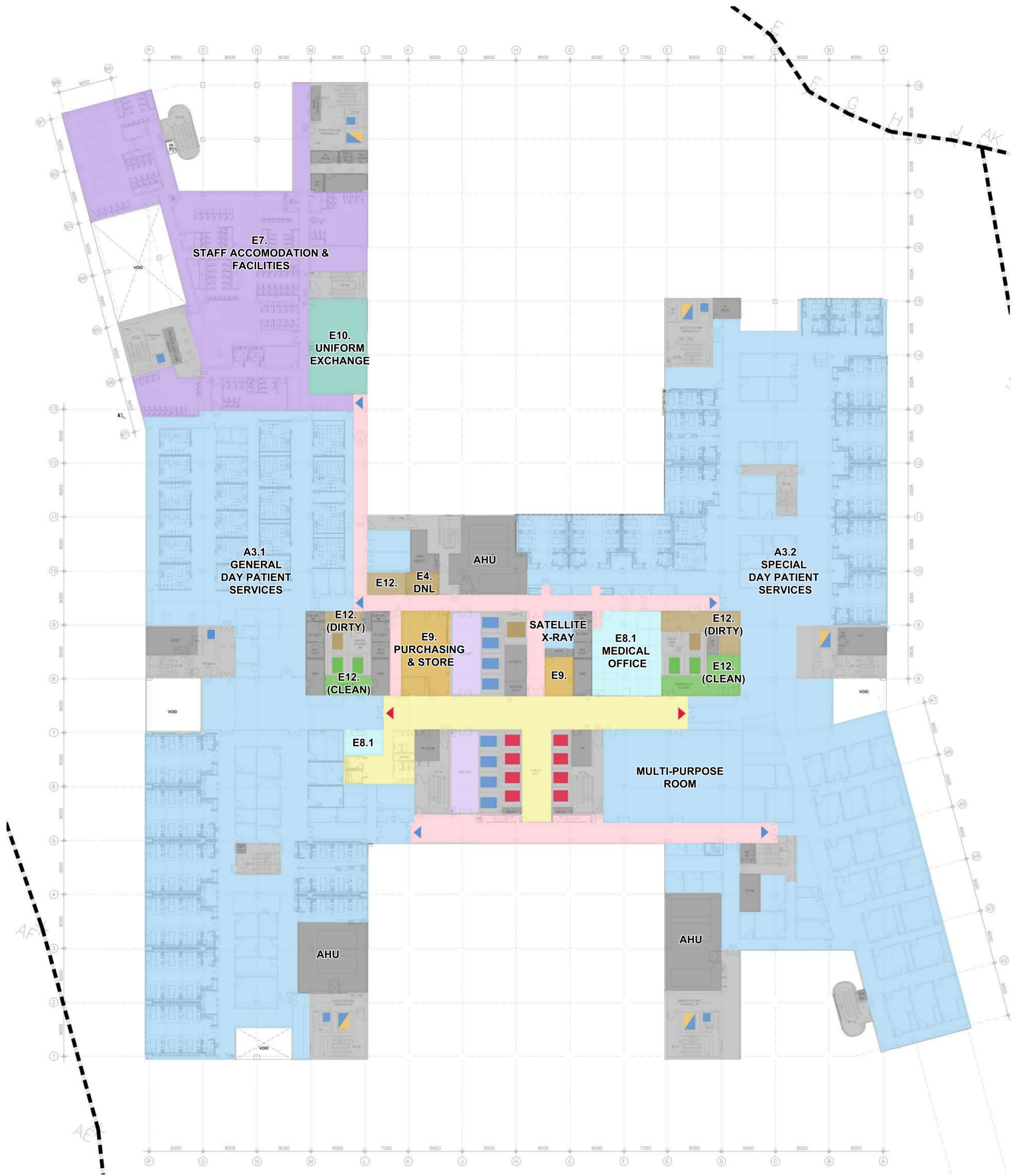

DESIGN APPROVAL
 We confirm that the architectural layout of this floor accepted with comment(s), if any, as stated in my covering letter.

For Chinese Medicine Hospital
 Dr. Cheung Wai Lun, JP
 Project Director (CMHPO)
 Food and Health Bureau

Date: _____

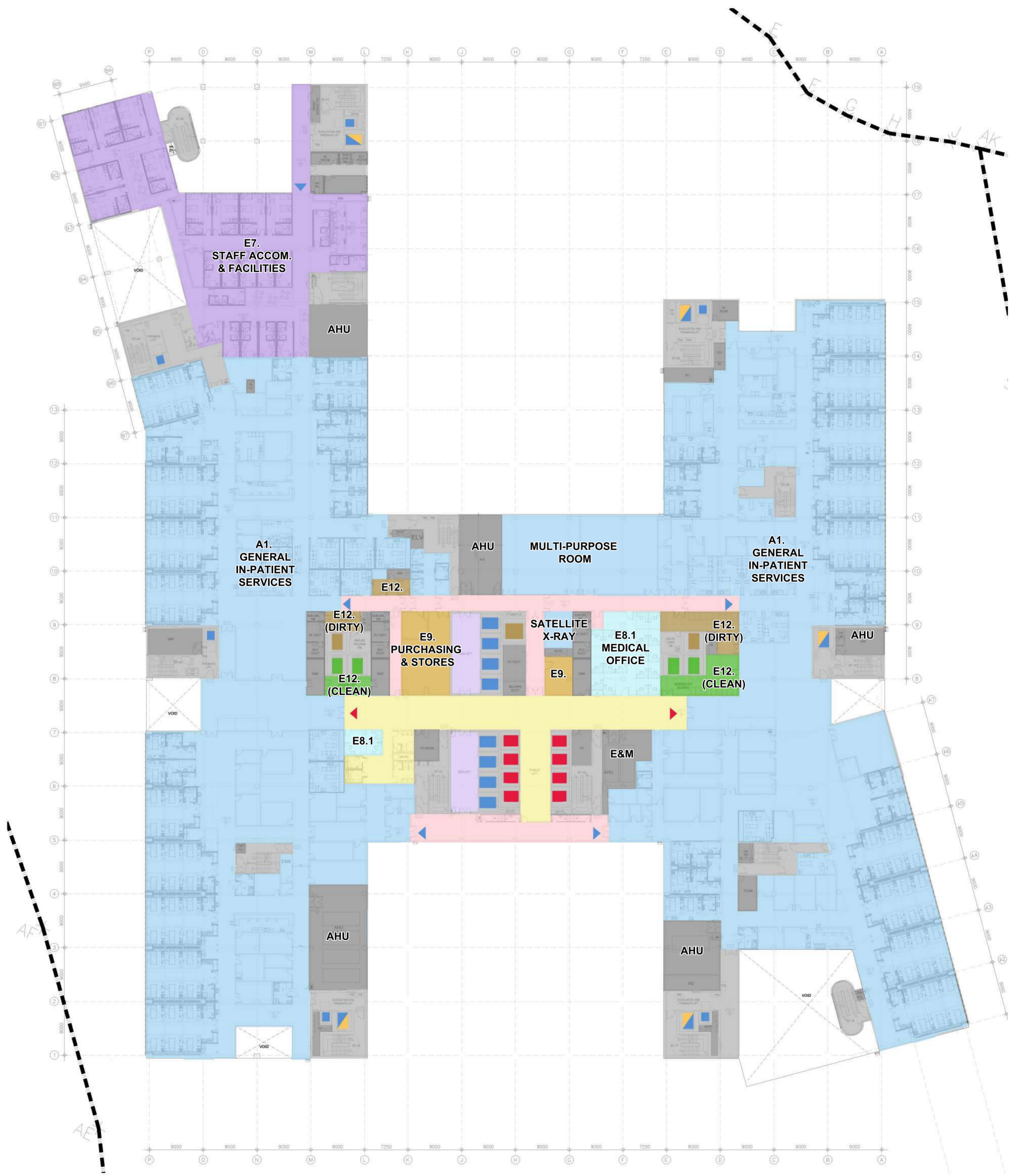

DESIGN APPROVAL
 We confirm that the architectural layout of this floor accepted with comment(s), if any, as stated in my covering letter.

For Chinese Medicine Hospital
 Dr. Cheung Wai Lun, JP
 Project Director (CM/PHO)
 Food and Health Bureau

Date: _____

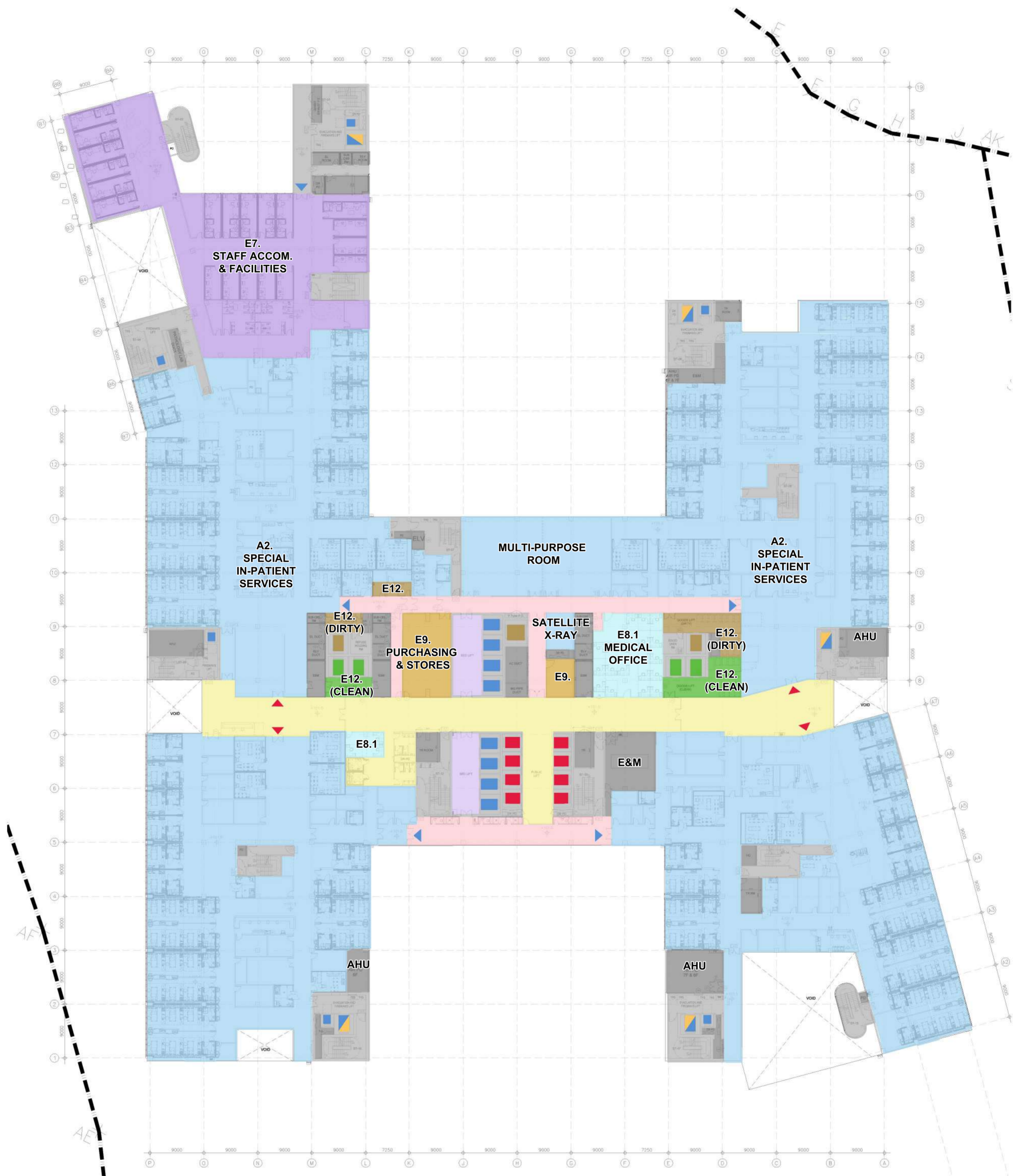

DESIGN APPROVAL
 We confirm that the architectural layout of this floor accepted with comment(s), if any, as stated in my covering letter.

For Chinese Medicine Hospital
 Dr. Cheung Wai Lun, JP
 Project Director (CMHPO)
 Food and Health Bureau

Date: